

Now  
Generation 3  
Quick Start Guide

- A Flash
- B Shutter Button
- C Film Shield
- D Light Meter
- E Camera Lens
- F Mode Indicator
  - Single Press for Self Timer
  - Double Press for Double Exposure
- G Mode Button
- H Film Door Button
- I Viewfinder
- J Flash ON | OFF Button
- K Camera ON|OFF Button
- L Film Counter LED
- M Battery Level Indicator
  - Battery full
  - Battery half full
  - Battery low
- N USB-C Charging Port

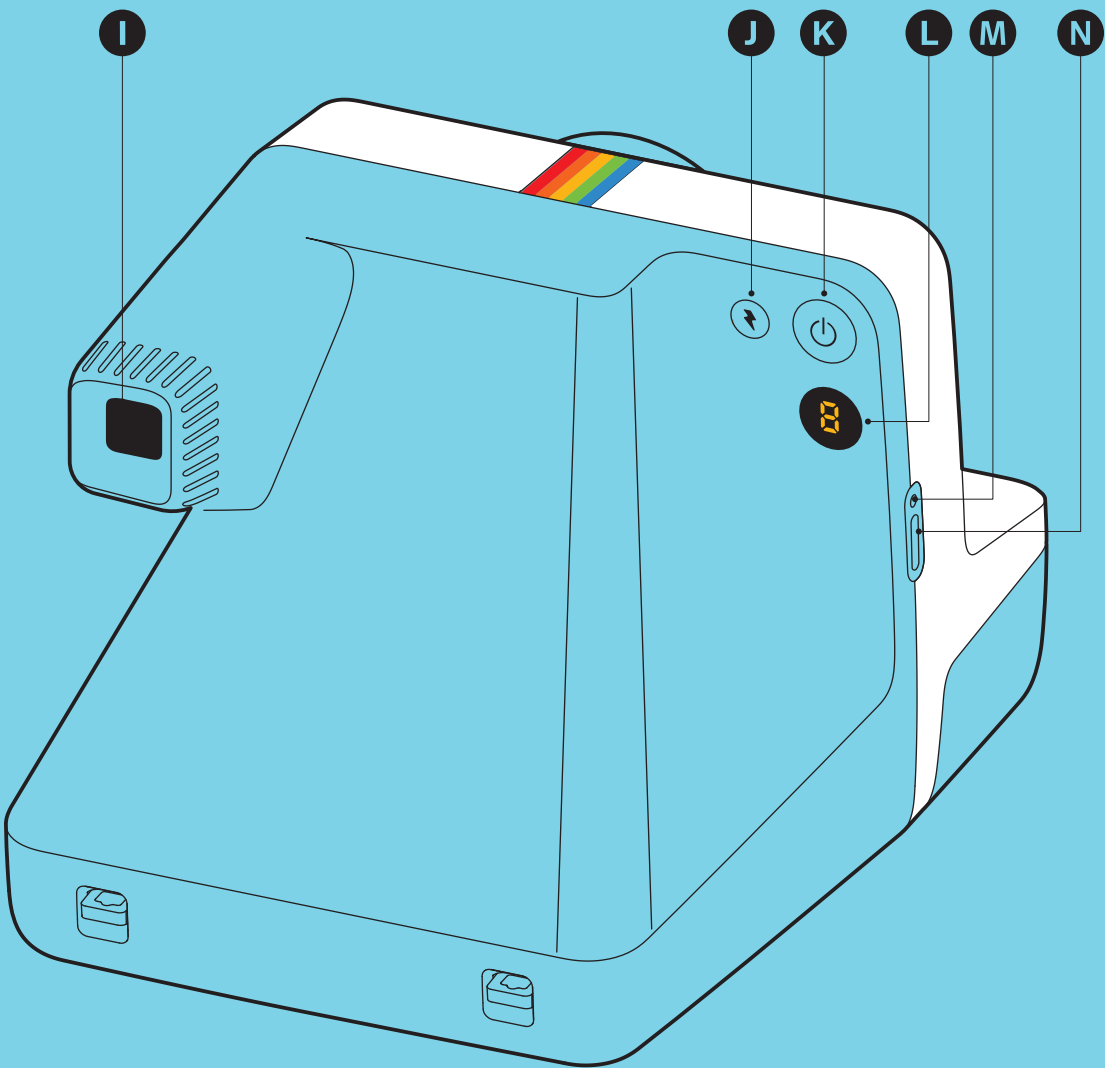

## 1. Get Started



Scan the QR code to get the app, free additional warranty, tips, manuals and more

[polaroid.link/now](https://polaroid.link/now)

## 2. Turn On

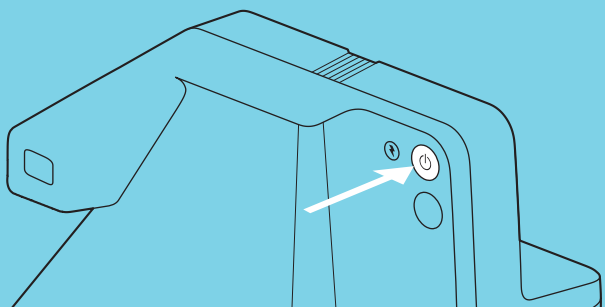

## 3. Load film

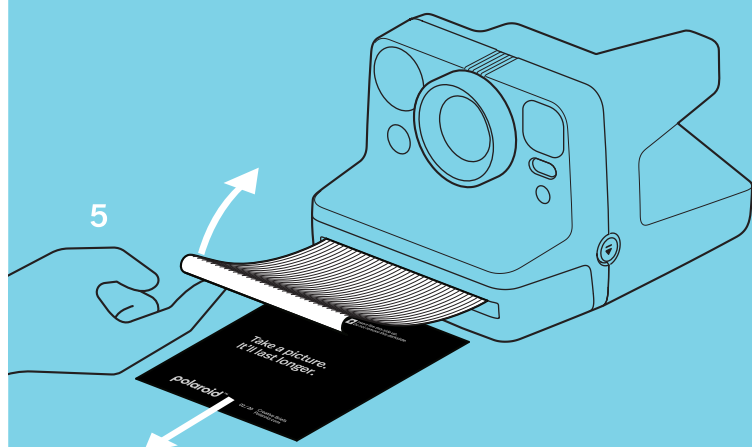
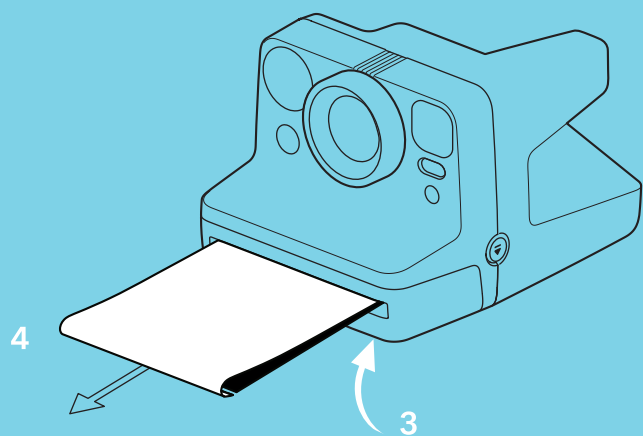
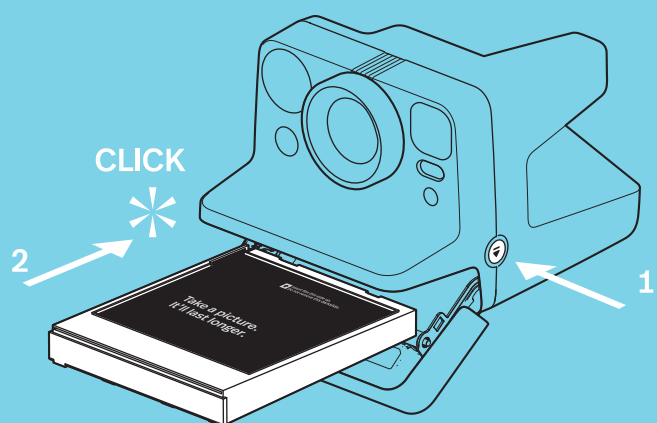

## 4. Take a Shot

Aim camera, half-press the shutter button to focus, full press to shoot.

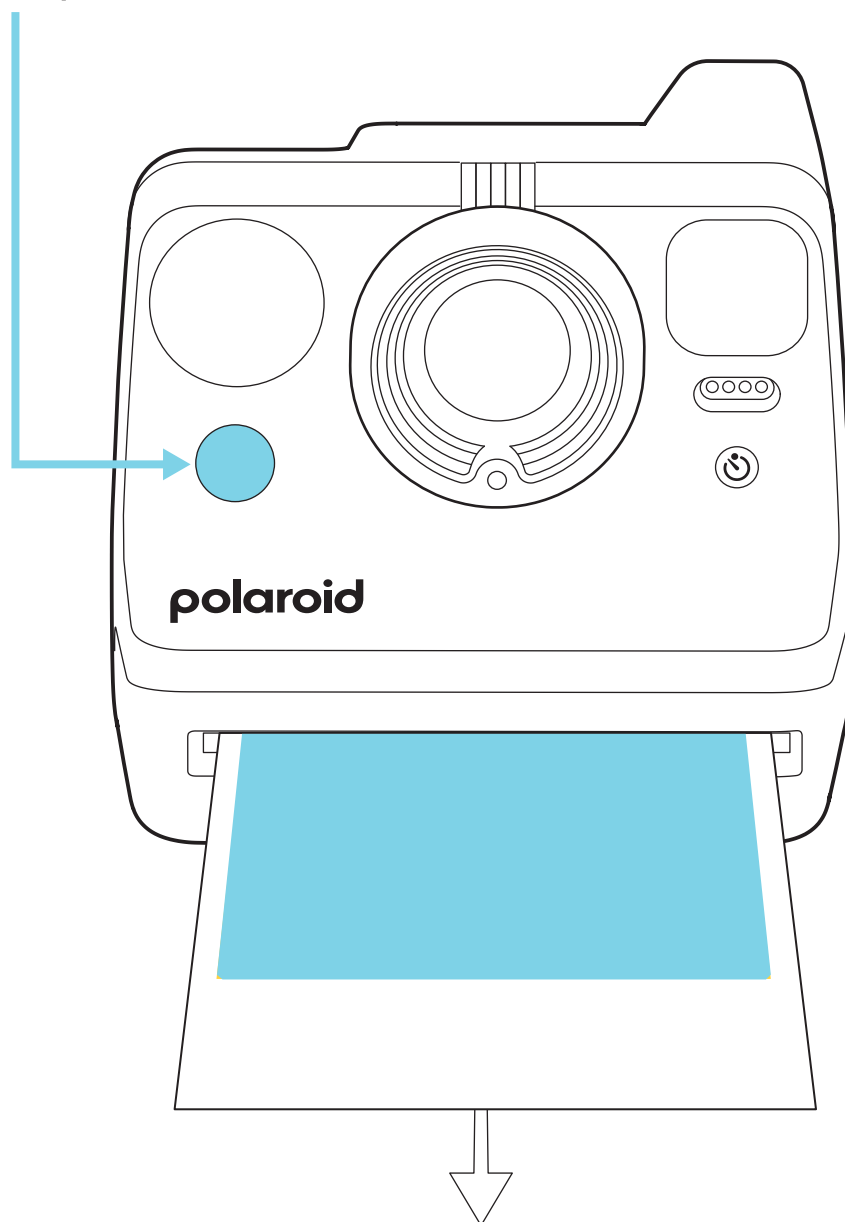

## 5. The Magic



Don't shake the picture! Place it in a dark area or face down on a flat surface and wait for the magic to develop.

